





Amenities

- Prime Location
- Vastu Compliance Design
- Balcony in each flat
- 3 side open apartment
- Lift of a reputed brand
- G+4 Storey Construction
- 3 BHK Apartments
- 8 Nos. Residential flats
- 50% Open Space
- Parking Space (on extra payment)

Specifications

○ Foundation	Earthquake Resistant RCC Framed Structure.
○ Wall Finishings	Interior - wall putty including one coat of primer. Exterior - superior quality finish with weather coat paint. Toilets - ceramic tiles dado upto door height. Kitchen - ceramic tiles dado upto 2.5 feet above counter.
○ Flooring	Rooms, living room and balcony-vitrified tiles. Kitchen and toilet tiles.
○ Door & Frames	Door-water resistant flush door with standard fittings. Door frames - wooden frames.
○ Windows	Aluminium sliding windows with grill and glass panel.
○ Electricals	Concealed copper wiring of ISI marked, standard make. Protective mcbs and modular branded switches, ISI marked. Provisions for adequate power outlets. TV socket in living room and master bedroom. Inverter point in each apartment. AC points in all bedrooms.
○ Sanitarywares	Western commode and wash basin in wash rooms. One wash basin in living room. (jaquar or equivalent) Cp fittings of reputed brand. (jaquar or equivalent)
○ Others	Granite counter top with stainless steel sink in kitchen Provision of aquaguard or similar water purifier.

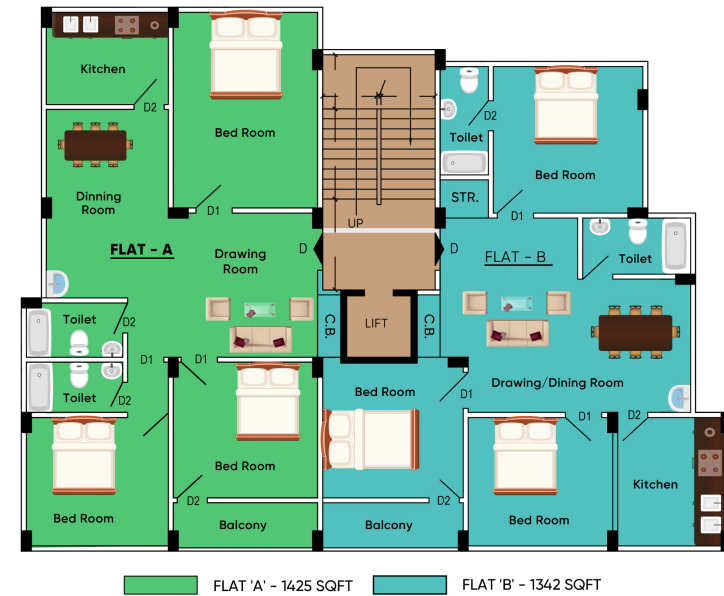

TYPICAL FLOOR PLAN

Flat No.	Type	BUA	Common Area	SBUA
A	3 BHK	1072	116	1425
B	3 BHK	1015	104	1342

*Areas mentioned above are in Sq Ft.

Olive Residency is an integrated residential complex which is located in 'Shantiniketan Housing Complex.' Olive Residency is an epitome of both contemporary design and quality construction with elegantly crafted apartments equipped with basic modern amenities and excellent features making it a perfect dream home. The complex has spacious 3 BHK Apartments with abundance of convenience, luxury and safety.

It is one of the finest project which is not only driven by thoughtful planning, finest craftsmanship and uncompromised quality of raw materials but it also desires to deliver a home rather than just a concrete apartment. Each & every detail has been taken care of to make Olive Residency stand out.

Location Map:

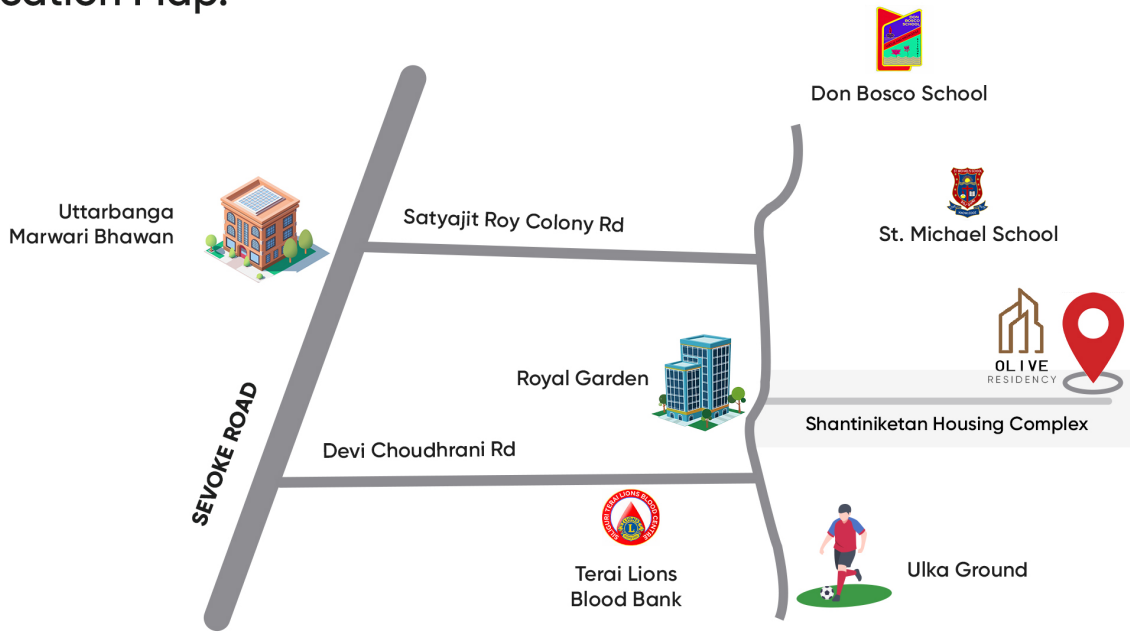

O L I V E
RESIDENCY

Site's Location: Shantiniketan Housing Complex
Jyotinagar, Siliguri-734001, Dist. Jalpaiguri, West Bengal

Developed by:



For Bookings:

📞 97355 52700 / 98320 30868

Note: This brochure is purely conceptual and not a legal document. The view, layout and the details of the amenities and facilities mentioned in this brochure are subject to change at the sole discretions of the developer and or the architect without any reference. The photographs and graphic used in this brochure are artist's impressions only.

Project Logo, Concept, Design by Primsy India. Contact 89273 25178